

Job Name:

Engineer/Architect:

Job Location:

Wholesaler:

Submittal Date:

Contractor:

## DRS84X Integral Shut-Off Straight Stop w/ Lock Shield & Screwdriver Slot – Female Sweat x Male Iron Pipe

**Use:** For use in potable water distribution systems in accessible locations only. Not intended for recirculating water systems that produce continuous use temperatures above 115° F. For those applications use our KT™ series ball stop.

**Design Features:**

- **Machined one-piece brass body** provides strength, durability, and long-lasting performance
- **Screwdriver slot handle** helps protect against accidental stop operation during rough-ins and in general use



**Operating Specifications:**

**Temperature:** 40° - 160° F

**Pressure:** 125 PSI maximum

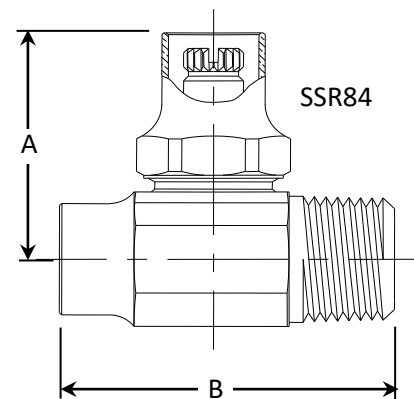
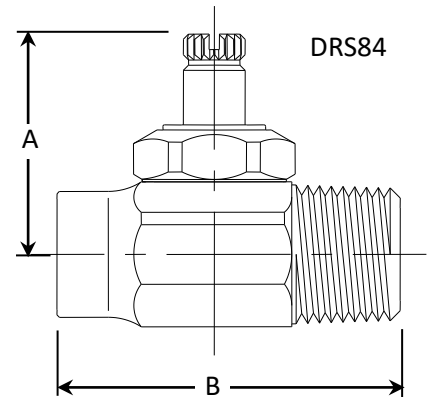

**STOP MATERIAL SPECIFICATIONS**

<b>Body</b>	Brass
<b>Screwdriver Slot Stem</b>	Brass
<b>Bib &amp; Packing Washers</b>	Rubber
<b>Packing Nut</b>	Brass

**PART DIMENSIONS (Inches)**

Model	DIM. A	DIM. B
DRS84X	1.38	2.01
SSR84X	1.52	2.01

**Part Listing:**

- DRS84X R 1/2" nom female sweat x 1/2" MIP with screwdriver slot, rough brass

**Listings & Certifications:**

- IAPMO listed to ASME A112.18.1 /CSA B125.1 (includes NSF/ANSI 372 and NSF/ANSI/CAN 61)



*This specification and all information contained herein is the confidential and exclusive property of BrassCraft Manufacturing Company and shall not be disclosed to others without the written consent of BrassCraft. This specification must be returned to BrassCraft if requested.*

400.132 DRS84X Integral Shut-Off w/Screwdriver Slot-Sweat x MIP REV 6.21

**BrassCraft®**

©2021 BrassCraft Manufacturing Company