

The Best Products, The Best Service...

SERVICE METAL

ONE CALL GETS IT ALL



Weld Neck Flange CLASS 150 Inches / Pounds

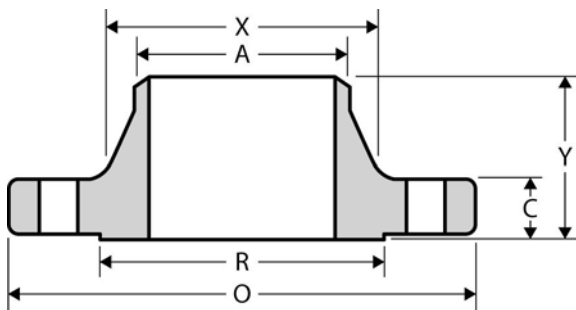

Nominal Pipe Size	Outside Diam. of Flange (O)	Thick. of Flange (C)	Diam. of Raised Face (R)	Diam. of Hub at Base (X)	Diam. of Hub at Point of Welding (A)	Length thru Hub (Y)	No. of Holes	Diam. of Holes	Diam. of Bolts	Diam. of Bolt Circle	Approx. Weight (in Pounds)
1/2	3.50	0.44	1.38	1.19	0.84	1.88	4	0.62	0.50	2.38	2
3/4	3.88	0.50	1.69	1.50	1.05	2.06	4	0.62	0.50	2.75	2
1	4.25	0.56	2.00	1.94	1.32	2.19	4	0.62	0.50	3.12	3
1 1/4	4.62	0.62	2.50	2.31	1.66	2.25	4	0.62	0.50	3.50	3
1 1/2	5.00	0.69	2.88	2.56	1.90	2.44	4	0.62	0.50	3.88	4
2	6.00	0.75	3.62	3.06	2.38	2.50	4	0.75	0.62	4.75	6
2 1/2	7.00	0.88	4.12	3.56	2.88	2.75	4	0.75	0.62	5.50	8
3	7.50	0.94	5.00	4.25	3.50	2.75	4	0.75	0.62	6.00	10
3 1/2	8.50	0.94	5.50	4.81	4.00	2.81	8	0.75	0.62	7.00	12
4	9.00	0.94	6.19	5.31	4.50	3.00	8	0.75	0.62	7.50	15
5	10.00	0.94	7.31	6.44	5.56	3.50	8	0.88	0.75	8.50	19
6	11.00	1.00	8.50	7.56	6.63	3.50	8	0.88	0.75	9.50	24
8	13.50	1.12	10.62	9.69	8.63	4.00	8	0.88	0.75	11.75	39
10	16.00	1.19	12.75	12.00	10.75	4.00	12	1.00	0.88	14.25	52
12	19.00	1.25	15.00	14.38	12.75	4.50	12	1.00	0.88	17.00	80
14	21.00	1.38	16.25	15.75	14.00	5.00	12	1.12	1.00	18.75	110
16	23.50	1.44	18.50	18.00	16.00	5.00	16	1.12	1.00	21.25	140
18	25.00	1.56	21.00	19.88	18.00	5.50	16	1.25	1.12	22.75	150
20	27.50	1.69	23.00	22.00	20.00	5.69	20	1.25	1.12	25.00	180
24	32.00	1.88	27.25	26.12	24.00	6.00	20	1.38	1.25	29.50	260

* Dimensions conform to ASTM A/SA-105; ANSI B16.5

* Bore to be determined at time of order.