

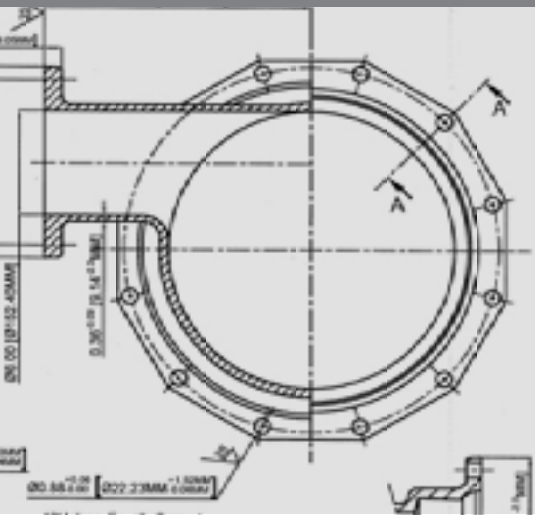

Quality – Service – Commitment – Delivered.

C153 DUCTILE IRON MECHANICAL JOINT FITTINGS



C153 DUCTILE IRON MECHANICAL JOINT FITTINGS BASIC SPECIFICATIONS

- SIZES:**
- 2" - 64"
- MATERIAL:**
- Ductile Iron ASTM A536, Grade 65-45-12, 60-42-10 or 70-50-05.
- PRESSURE:**
- 350 PSI Water Working Pressure 2" - 24".
 - 250 PSI Water Working Pressure 30" - 48".
 - 150 PSI Water Working Pressure 54" - 64".
- TESTING:**
- In accordance with ANSI/AWWA C153/A21.53.
 - In accordance with UL - FM requirements.
 - All fittings are hydrostatically tested in accordance with SIGMA Quality Management Standard.
 - All fittings are heat coded to ensure traceability and verification of metallurgical properties in accordance with the prevailing standards and SIGMA Quality Management Standards.
- LAYING LENGTH:**
- Short body design - straight section of body deleted to provide a compact and lighter fitting without reducing strength or flow characteristics.
- DEFLECTION:**
- In accordance with ANSI/AWWA C153/A21.53.
 - Maximum allowable deflection for MJ Joint on a full length pipe is as mentioned below:
 1. 3" - 4" = 8 Degrees
 2. 6" = 7 Degrees
 3. 8" - 12" = 5 Degrees
 4. 14" - 48" = 3 Degrees
- CEMENT LINING:**
- Double cement lined in accordance with ANSI/AWWA C104 / A21.4.
- COATING:**
- Interior of fitting is seal coated (asphaltic material) in accordance with ANSI AWWA C104/A21.4 and NSF61 approved.
 - Exterior of fitting is seal coated (asphaltic material) in accordance with ANSI/AWWA C153/A21.53 and NSF approved.
- GASKETS:**
- SBR in accordance with ANSI/AWWA C111/A21.11.
 - Also available in EPDM, NBR and CR.
- T-BOLTS:**
- Low Alloy corrosion resistant high strength steel in accordance with ANSI/AWWA C111/A21.11.
- APPROVALS:**
- 3"-16" Underwriters Laboratories listed and Factory Mutual Approved.
- STANDARDS:**
- Certified to NSF61 Standard including Annex G & 372.
 - ANSI/AWWA C153/A21.53 for Compact Ductile Iron Fittings 2"-64" for water and other liquids.
- INSTALLATION:**
- Per ANSI/AWWA C600 and C111 using DIP conforming to C150/C151 and PVC pipe conforming to C900/C905.

C153 DUCTILE IRON MECHANICAL JOINT FITTINGS

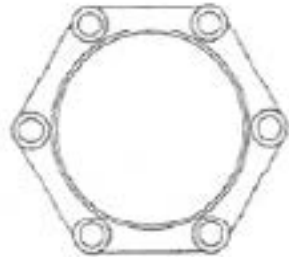

MJ Glands

Size	Item No.	Wt.
2	DG2	2
3	DG3	4
4	DG4	5
6	DG6	6
8	DG8	7
10	DG10	10
12	DG12	15
14	DG14	23
16	DG16	28
18	DG18	30
20	DG20	43
24	DG24	50
30	DG30	85
36	DG36	115
42	DG42	180
48	DG48	275

Mechanical Joint Accessories



MJ Gaskets

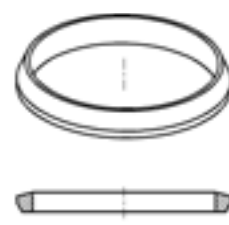

TG Gaskets

Size	Item No.	Wt.	Item No.	Wt.
2	MG2		TG3	0.50
3	MG3	0.25	TG4	0.60
4	MG4	0.30	TG6	0.75
6	MG6	0.50	TG8	1.10
8	MG8	0.75	TG10	1.30
10	MG10	0.80	TG12	1.65
12	MG12	1.00		
14	MG14	1.30		
16	MG16	1.45		
18	MG18	1.60		
20	MG20	1.90		
24	MG24	2.10		
30	MG30	2.30		
36	MG36	2.75		
42	MG42	3.20		
48	MG48	3.65		

Gasket/Bolt Packs

Size (in.)	Item No.	Wt. (lb.)
3	MGP3	3
4	MGP4	4
6	MGP6	6
8	MGP8	7
10	MGP10	8
12	MGP12	9

MJ Gland Packs

Size (in.)	Item No.	Wt. (lb.)
2	DGP2	6
3	DGP3	7
4	DGP4	8
6	DGP6	12
8	DGP8	15
10	DGP10	20
12	DGP12	25
14	DGP14	37
16	DGP16	43
18	DGP18	47
20	DGP20	61
24	DGP24	72

Includes: Gland, MJ Gasket, and Standard Tee Bolts & Nuts

C153 MJ Non-Standard Items:

Item #	Description
•DCL16	C153 DI 16" X 16" MJ X MJ CUT-IN SLEEVE
•DMB1612	C153 DI 16" X 12" MJ X MJ REDUCING BEND
•DMB1830	C153 DI 18" X 30" MJ X MJ 30 BEND
•DMB211	C153 DI 2" MJ x MJ 11-1/4 DEGREE BEND
•DMB222	C153 DI 2" MJ x MJ 22-1/2 DEGREE BEND
•DMB2405	C153 DI 24" X 24" MJ X MJ 5-5/8 DEGREE BEND
•DMB3005	C153 DI 30" X 30" MJ X MJ 5-5/8 DEGREE BEND
•DMB3605	C153 DI 36" X 36" MJ X MJ 5-5/8 DEGREE BEND
•DMB4205	C153 DI 42" X 42" MJ X MJ 5-5/8 DEGREE BEND
•DMB4260	C153 DI MJ 42X60 BEND
•DMB4805	C153 DI 48" X 48" MJ X MJ 5-5/8 DEGREE BEND
•DMB4830	C153 DI 48" X 30" MJ X MJ 30 DEGREE BEND
•DMC186	C153 DI 18" X 6" MJ X MJ CROSS
•DMF103	C153 DI 10" X 3" MJ X FLG TEE
•DML2	C153 DI 2" X 2" MJ X MJ LONG SLEEVE
•DTK2	C153 DI 2" MJ CAP (TAPPED)
•PPR83	C153 DI 8" X 3" PE X PE CONCENTRIC REDUCER
•SPR62	C153 DI 6" X 2" PE X MJ SEB CONCENTRIC REDUCER
•SPR83	C153 DI 8" X 3" PE X MJ SEB CONCENTRIC REDUCER
•SSA824	C153 DI 8" X 24" SOLID X SWL ADAPTER
•SSA836	C153 DI 8" X 36" SOLID X SWL ADAPTER
•TG2	2" MJ TRANS RUBBER GSKT
•DML2	C153 DI 2" X 2" MJ X MJ LONG SLEEVE
•DMR4220	C153 DI 42" X 20" MJ X MJ CONCENTRIC REDUCER
•DMR4820	C153 DI 48" X 20" MJ X MJ CONCENTRIC REDUCER
•DMR83	C153 DI 8" X 3" MJ X MJ CONCENTRIC REDUCER
•DMT304	C153 DI 30" X 4" MJ X MJ TEE
•DMT62	C153 DI 6" X 2" MJ X MJ TEE

Note: Contact SIGMA for more information on non-standard fittings.

Low Alloy, Corrosion Resistant Steel T-Head Bolts

Standard Bolts

Size (in.)	Item No.	Wt. (lb.)
5/8 x 3	TB30	0.5
3/4 x 3 1/2	TB35	0.75
3/4 x 4	TB40	0.85
3/4 x 4 1/2	TB45	1
3/4 x 5	TB50	1.25
1 x 6	TB60	2.25
1 1/4 x 6	TB61	2.5

Anti-Rotation Bolts

Size (in.)	Item No.	Wt. (lb.)
3/4 x 3	ATB35	0.75
3/4 x 4	ATB40	1
3/4 x 4	ATB45	1.25
3/4 x 5	ATB50	1.5

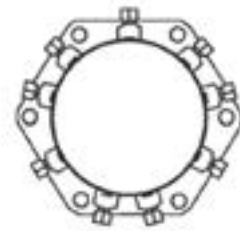

Retainer Packs

Size	Item No.	Wt.
3	RGP3	9
4	RGP4	10
6	RGP6	15
8	RGP8	19
10	RGP10	25
12	RGP12	32

MJ Retainer Glands

Pipe Size	Item No.	Wt.	IRON PIPE O.D.	Rating (psi)	Set Screws		
					Qty	Size	Torque (ft-lbs)
3	RMG3	5	3.96	350	4	5/8 X 2	85
4	RMG4	7	4.80	350	4	5/8 X 2	85
6	RMG6	12	6.90	350	6	5/8 X 2	85
8	RMG8	16	9.05	250	9	5/8 X 2	85
10	RMG10	22	11.10	250	16	5/8 X 2	85
12	RMG12	28	13.20	250	16	5/8 X 2	85
14	RMG14	45	15.30	250	20	5/8 X 2	85
16	RMG16	52	17.40	250	24	5/8 X 2	85
18	RMG18	62	19.50	200	24	5/8 X 2	85
20	RMG20	75	21.60	200	28	3/4 X 2-1/2	110
24	RMG24	97	25.80	200	32	3/4 X 2-1/2	110
30	RMG30	196	32.00	100	40	3/4 X 2-1/2	110
36	RMG36	246	38.30	100	48	3/4 X 2-1/2	110
42	RMG42	302	44.50	100	56	3/4 X 2-1/2	110
48	RMG48	380	50.80	100	64	3/4 X 2-1/2	110

Transition Gland Pack - (includes Gland, Transition Gasket and Std. T-head bolts)

Size	Item No.	Wt.
3	DXP3	7
4	DXP4	8
6	DXP6	12
8	DXP8	15
10	DXP10	20
12	DXP12	25