

QuickFitting® Stainless Steel push-to-connect fittings deliver a patented design, superior sealing performance, and the highest corrosion resistance in both residential and commercial installations for joining of copper, PEX (with stiffener) and CPVC. Available in larger sizes (1-1/4" – 2").

Features and Benefits

- 100% lead free, corrosion-resistant Stainless Steel
- Fast, simple push-to-connect installation
- No tools, crimping, glue or flames needed
- Safe for potable water applications
- Compatible with Copper, CPVC, & PEX
- U.S. Manufactured Grip Ring Technology
- Approved for behind the wall or direct burial (no wrap required)
- Easy removal with our patented Slip Clip™ Release Tool
- 75-Year Warranty (25-Years if Direct Burial)

Specification Data

Materials

- Body Construction: AISI 304 Stainless Steel
- O-Ring: EPDM
- Grip Ring: AISI 301 Stainless Steel
- Tube Stiffener: Glass-filled Nylon (1/2"-1") or Copper (1-1/4"-2")

Performance

- Maximum Working Pressure: 250 psi
- Maximum Temperature: 200° F
- Applications: Indoor or outdoor plumbing, heating repair, marine repair, RV & mobile home repair, irrigation

Certifications and Listings

IAPMO listed as in compliance with the following standards:

- ASSE 1061-2015
- NSF/ANSI/CAN 61-2019
- NSF/ANSI/CAN 372-2020

Fitting Size	Insertion Depth
1/2"	1"
3/4"	1-3/16"
1"	1-3/16"
1-1/4"	1-7/8"
1-1/2"	2-1/8"
2"	2-3/16"

Item # Submitted	
Job Name	
Date	
Engineer	
Contractor	
PO #	
Tag	

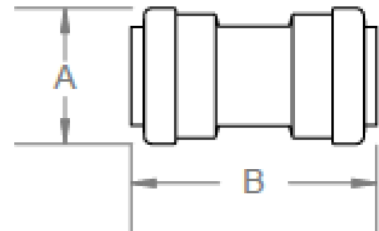
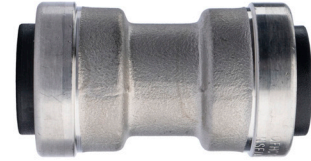

Dimensional Data

Part No.	Size	A	B
SS811R	1/2"	1.06"	1.94"
SS821R	3/4"	1.35"	2.46"
SS831R	1"	1.75"	2.45"
SS851R	1-1/4"	2.12"	3.7"
SS861R	1-1/2"	2.57"	4.25"
SS871R	2"	2.95"	4.43"