

BASIN DIA.	'A'	'B'	'C'	'D'	'E'	'F'	'G'	'H'
24"	24.10	30.00	28.25	AS REQ'D	24.00	26.50	3.00	11GAGE(.119)
30"	30.10	36.00	34.25	AS REQ'D	30.00	32.50	3.00	11GAGE(.119)
36"	36.10	42.00	40.25	AS REQ'D	36.00	38.50	3.00	11GAGE(.119)
42"	42.10	48.00	46.50	AS REQ'D	42.00	44.50	3.19	6GAGE(.194)
48"	48.10	54.00	54.55	AS REQ'D	48.00	51.00	3.19	6GAGE(.194)
60"	60.10	66.00	66.55	AS REQ'D	60.00	63.00	3.19	1/4"(.250)

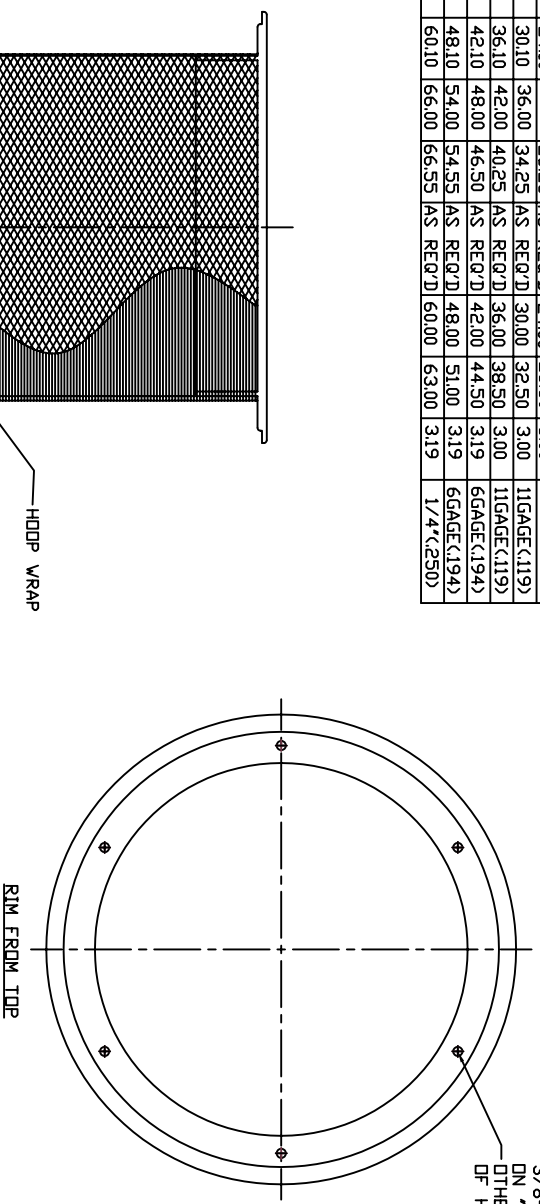

- 1, AVAILABLE WITHOUT BASEPLATE.
- 2, STEEL BASEPLATES AVAILABLE ALL SIZES.
- 3, FIBERGLASS BASEPLATES AVAILABLE ON 24",30",36" AND 48" DIAMETER BASINS.

JACKEL BASINS ARE WOUND WITH A PROPRIETARY COMBINATION OF HDOP AND HELICAL WRAPS TO SUPPLY MAXIMUM STRENGTH AND RIGIDITY FOR EACH BASIN SIZE.COLDER BLUE

THICKNESS OF JACKEL'S FWRP BASINS ARE DETERMINED BY BASIN DIAMETER AND LENGTH. THICKNESS OF GIVEN BASIN WILL BE SUPPLIED UPON REQUEST TO JACKEL,INC.

3/8-16 THREADED INSERTS ON "F" BOLT CIRCLE (6) OTHER SIZES AND NUMBER OF HOLES SUPPLIED UPON RFO

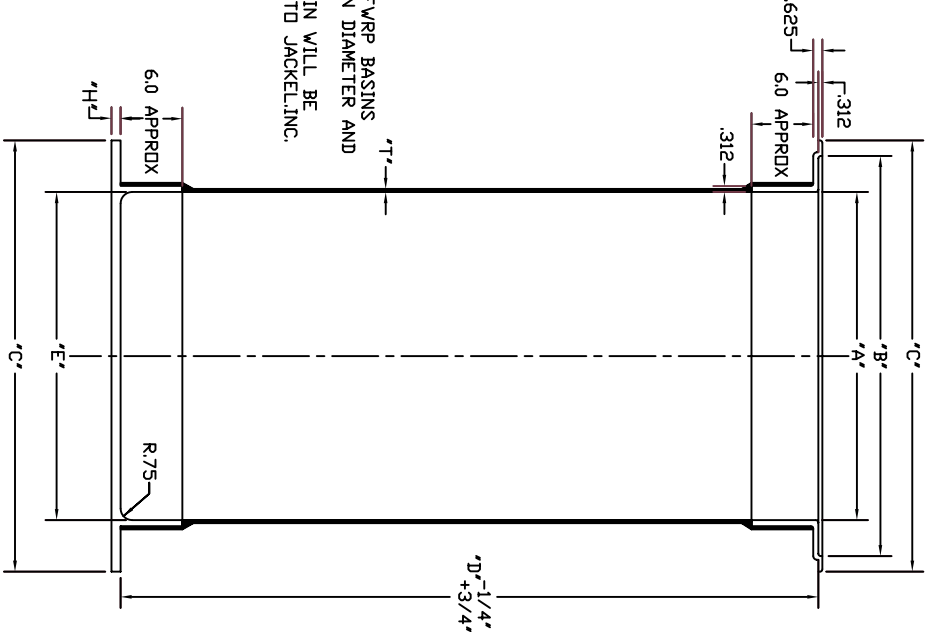

**TOLERANCES:**

LENGTH 'D' -.25 +.75  
TOP RING FLANGE FLATNESS +/- 2 DEGREES

**JACKEL, INC.**  
15314 HARRISON ROAD  
MISHAWAKA, INDIANA 46544 USA

FIBERGLASS FILAMENT WOUND BASINS

REVISION LEVEL	DATE	BY	DESCRIPTION
A	08-28-03	J.M.S.	NTS
DESIGNED BY	1		
CHECKED BY	1		

FOR THE: J.HASLOCK