

FEATURES

- Ideal for warehouses and industrial buildings. Small size and light weight makes for an easy installation
- With efficiencies up to 185 LPW, the PELA is an excellent choice when ROI is the key decision criteria
- Options for lumen packages up to 60,000 lumens provides outstanding coverage for the majority of high bay applications
- Integrated sensor options for code compliance, grouping of fixtures, increased energy savings, and connection to NX Lighting Controls systems
- Optimized bulk packaging to minimize job site space requirements and ease waste removal
- Designed for unconditioned spaces through a 50°C ambient temperature rating and a -30°C rating for refrigerated spaces.



NXWHM, NXEHM



RELATED PRODUCTS

Ø [Echelán High Bay](#)

SERVICE PROGRAMS

STOCK QS10

CONTROL TECHNOLOGY

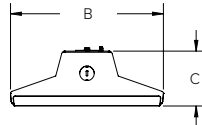

Typical Dimensions and Weights				
Sizes	(A) Length Inches	(B) Width Inches	(C) Height Inches	Weight (lbs)
1	19.59	9.21	3.30	6.0
2	13.75	10.88	3.46	10.0
3	27.30	10.88	3.60	20.0

*Size dependent on Lumen Code. See dimensions page.

SPECIFICATIONS

CONSTRUCTION

- Size 1 fixture housing is all steel while Size 2 & 3 are a combination of steel and aluminum. All provide exceptional durability and heat dissipation. All sizes are IK10 rated
- Fixture design provides easy access to electrical components by removal of bottom channel cover
- Robust white powder coating prevents chipping and/or flaking while providing protection in more demanding environments
- Access plate mounted on back of fixture providing easy access to make wiring connections
- Knockouts on both ends of fixture for electrical connection options

OPTICS

- Clear and diffuse optic options plus wide, narrow, and aisle light distributions on Size 2 & 3 bodies for layout flexibility
- Field changeable lens for maintenance and flexibility

INSTALLATION

- Mounting options include Chain/Cable mount, Surface mount, and Pendant mount

ELECTRICAL

- Light engine utilizing metal clad boards with high efficacy (up to 185 LPW), long life LEDs protect the fixtures lumen maintenance

ELECTRICAL (CONT'D)

- Driver options include 3kV standard surge protection in 120–277V input or 6kV standard surge protection in 347–480V input
- Power Factor >0.9 and THD <20 converts power efficiently & effectively into light
- Driver options for fixed light output or 0-10V dimming down to 10% is available to customize light levels

CONTROLS

- Integration of sensors (NX and other) accomplished through knockout in bottom middle of fixture which eliminates fixture potentially blocking sensor
- High-end trim, occupancy and ambient light detection with dimming available
- NX Lighting Controls provides options for standalone and networked integrated sensor with wired or wireless connectivity for NX system deployments
- NX Connect is a standalone wireless deployment for room based applications using wireless enabled and battery operated devices
- DLC 5.1 Integrated/embedded networked lighting controls, luminaire-level lighting controls (LLC) certified

CERTIFICATIONS

- Emergency battery pack options are California Energy Commission (CEC) Title 20 Compliant
- All luminaires are built to UL1598 standard
- Damp location labeling is standard
- UL/cUL Listed
- DLC® (DesignLights Consortium) Qualified. Please refer to the DLC® website for specific product qualifications at www.designlights.org
- Product configurations not including battery packs or controls meet federal procurement law requirements under the Trade Agreements Act (FAR 52.225-11). See [Buy America\(n\) Solutions](#)
- For -BAA Option: This product meets federal procurement law requirements under the Buy American Act (FAR 52.225-9). See [Buy America\(n\) Solutions](#)

WARRANTY

- 5 year warranty
- See [HLI Solutions Standard Warranty](#) for additional information

DATE:

LOCATION:

TYPE:

PROJECT:

CATALOG #:

ORDERING GUIDE

Gray Shading = Service Program
Limit of 800 luminaires

QS10

Example: PELA-840-L24-B-ED-U-ST

PELA						
Model	CRI/CCT	Lumen Output	Distribution	Driver	Voltage	Mounting
PELA Linear High Bay	740 4000K 70 CRI	L09 9,000 lm	A No Lens (120°)	ED 0-10V Dimming	U 120-277V	ST Standard
	750 5000K 70 CRI	L12 12,000 lm	B Diffused Lens (120°)	E Fixed Output	120 120V	SM ¹ Surface Mount
	840 4000K 80 CRI	L15 15,000 lm	C ⁵ Clear Lens (120°)		277 277V	PM ¹ Pendant Mount
	850 5000K 80 CRI	L18 18,000 lm	D ⁵ Diffused Lens (55°)		347 347V	
		L24 24,000 lm	E ⁵ Diffused Lens (30°)		480 480V	
		L30 30,000 lm				
		L36 36,000 lm				
		L48 48,000 lm				
		L60 60,000 lm				

Options (Leave Blank if None Needed)	Controls (Leave Blank if None Needed)
PI Packaged Individually	NX Lighting Controls
ELL20^{1,9,11} 20W Emergency Battery Pack (CEC Title 20 compliant) Installed	<u>Networked Wireless</u>
ELL30¹⁰ 30W Emergency Battery Pack (CEC Title 20 compliant) Installed	NXW NX Networked Wireless Radio Module NXRM2 and Bluetooth Programming, without Sensor
DTS Dimming Bypass Module	NXWHM NX Networked Wireless Enabled Integral NXSMP2-HMO PIR Occupancy Sensor with Automatic Dimming Photocell and Bluetooth Programming
BAA Buy American Act (FAR 52.225-9) Compliant	<u>Networked Wired</u>
Cord Options	NXE NX Wired Dual RJ45 SmartPORTS , without Sensor
F3C006 6', 3 conductor cord	NXEHM NX Wired Dual RJ45 SmartPORTS and Integral NXSMP2-HMO PIR Occupancy Sensor with Automatic Dimming Photocell and Bluetooth Programming
F3C012 12', 3 conductor cord	<u>Independent Control</u>
F4C006 6', 4 conductor cord (for ELL20 option)	NXCHM^{7,8} NX Connect NXC-WHS20 Wireless High Bay Occupancy & Photocell Sensor
F4C012 12', 4 conductor cord (for ELL20 option)	WSPD360 End Mounted WSPDEMUNV PIR Occupancy Sensor with Automatic Dimming Photocell and 360° Lens
F5C006 6', 5 conductor cord (Line + dimming)	WSPDA End Mounted WSPDEMUNV PIR Occupancy Sensor with Automatic Dimming Photocell and Aisle lens
F5C012 12', 5 conductor cord (Line + dimming)	WSPDBT360 End Mounted Bluetooth® Programmable, WSPDBEMUNV PIR Occupancy Sensor with Automatic Dimming Photocell and 360° Lens
Flexible Metal Conduit Options	WSPDBTA End Mounted Bluetooth® Programmable, WSPDBEMUNV PIR Occupancy Sensor with Automatic Dimming Photocell and Aisle Lens
C00388 6', 3 wire flexible metal conduit	OS1360 End Mounted WSPDEMUNV PIR Occupancy/Daylight Sensor with 360° Lens
C00488 6', 4 wire flexible metal conduit	OS1A End Mounted WSPDEMUNV PIR Occupancy/Daylight Sensor with Aisle Lens
C00588 6', 5 wire flexible metal conduit	<u>Other</u>
Cord with Plug Options (See NEMA Table Below)	<u>Independent Control</u>
C6TL15² 6' Cord with 15A TL plug	OS⁶ On/Off Sensor 360° high mount sensor
C6TL20³ 6' Cord with 20A TL plug	OCS⁶ On/ Off Occupancy/ Daylight Sensor 360° high mount sensor
C6P151⁴ 6' Cord with 15A straight blade plug	ODS⁶ Dimming Occupancy Sensor 360° high mount sensor

NEMA PLUG TYPE TABLE			
Voltage	TL15 15A Twist Lock	TL20 20A Twist Lock	P151 15A Straight
120V	L5-15P	L5-20P	5-15P
277V	L7-15P	L7-20P	7-15P
347V	N/A	L24-20P	24-15P
480V	N/A	L8-20P	N/A

- Notes:
- 1

ELL20 with 347/480V not available for mounting options SM and PM.
- 2

Only available with discrete voltage option codes: 120 or 277
- 3

Only available with discrete voltage option codes: 120, 277, 347, or 480
- 4

Only available with discrete voltage option codes: 120, 277, or 347
- 5

Only available with Lumen Output codes L24, L30, L36, and L48
- 6

Other sensors are programmable and sensors are typically side mounted
- 7

NX Connect devices can be customized with the NX Connect app, available on the Apple® App Store. Sensors are bottom mounted. See pictures on integrated sensor page.
- 8

High mount lens provided. For low, medium, or aisle distribution, order appropriate lens accessory and field change.
- 9

To determine the lumen output in emergency mode, multiply the battery pack wattage by the fixture lumens per watt (LPW)
- 10

Please consult factory on leadtime for this option
- 11

QS10 not available for ELL20 with cord options

STOCK GUIDE

DATE:	LOCATION:
TYPE:	PROJECT:
CATALOG #:	

STOCK

Control Option	Catalog No.	UPC	Description	Weight (lbs)	Pallet Qty	DLC QPL
None	<input type="checkbox"/> PELA-840-L24-B-ED-U-ST-PI	662055176361	80 CRI, 4000K, 24,000 Lumens, Diffuse Wide Distribution Polycarbonate Lens, 0-10V Dimming Driver, 120-277V, White	10	30	S-FXK5A2
	<input type="checkbox"/> PELA-850-L24-B-ED-U-ST-PI	662055176354	80 CRI, 5000K, 24,000 Lumens, Diffuse Wide Distribution Polycarbonate Lens, 0-10V Dimming Driver, 120-277V, White	10	30	S-F7Q6C3
	<input type="checkbox"/> PELA-840-L30-B-ED-U-ST-PI	603134946338	80 CRI, 4000K, 30,000 Lumens, Diffuse Wide Distribution Polycarbonate Lens, 0-10V Dimming Driver, 120-277V, White	10	30	S-F7Q6C3
	<input type="checkbox"/> PELA-850-L30-B-ED-U-ST-PI	662055176378	80 CRI, 5000K, 30,000 Lumens, Diffuse Wide Distribution Polycarbonate Lens, 0-10V Dimming Driver, 120-277V, White	10	30	S-F7Q6C3
	<input type="checkbox"/> PELA-840-L36-B-ED-U-ST-PI	603134946352	80 CRI, 4000K, 36,000 Lumens, Diffuse Wide Distribution Polycarbonate Lens, 0-10V Dimming Driver, 120-277V, White	20	20	S-F7Q6C3
	<input type="checkbox"/> PELA-850-L36-B-ED-U-ST-PI	662055176385	80 CRI, 5000K, 36,000 Lumens, Diffuse Wide Distribution Polycarbonate Lens, 0-10V Dimming Driver, 120-277V, White	20	20	S-DVLH5N
Independent (OS)	<input type="checkbox"/> PELA-840-L18-B-ED-U-ST-PI-OS	840141432625	80 CRI, 4000K, 18,000 Lumens, Integral On/Off Sensor, Diffuse Wide Distribution Polycarbonate Lens, 0-10V Dimming Driver, 120-277V, White	6	56	S-DVLH5N
	<input type="checkbox"/> PELA-840-L24-B-ED-U-ST-PI-OS	662055176408	80 CRI, 4000K, 24,000 Lumens, Integral On/Off Sensor, Diffuse Wide Distribution Polycarbonate Lens, 0-10V Dimming Driver, 120-277V, White	10	30	S-DVLH5N
	<input type="checkbox"/> PELA-850-L24-B-ED-U-ST-PI-OS	662055176392	80 CRI, 5000K, 24,000 Lumens, Integral On/Off Sensor, Diffuse Wide Distribution Polycarbonate Lens, 0-10V Dimming Driver, 120-277V, White	10	30	S-R52KE7
	<input type="checkbox"/> PELA-840-L30-B-ED-U-ST-PI-OS	662055176393	80 CRI, 4000K, 30,000 Lumens, Integral On/Off Sensor, Diffuse Wide Distribution Polycarbonate Lens, 0-10V Dimming Driver, 120-277V, White	10	30	S-R52KE7
	<input type="checkbox"/> PELA-850-L30-B-ED-U-ST-PI-OS	662055176415	80 CRI, 5000K, 30,000 Lumens, Integral On/Off Sensor, Diffuse Wide Distribution Polycarbonate Lens, 0-10V Dimming Driver, 120-277V, White	10	30	S-R52KE7
	<input type="checkbox"/> PELA-840-L36-B-ED-U-ST-PI-OS	603134946369	80 CRI, 4000K, 36,000 Lumens, Integral On/Off Sensor, Diffuse Wide Distribution Polycarbonate Lens, 0-10V Dimming Driver, 120-277V, White	20	20	S-R52KE7
	<input type="checkbox"/> PELA-850-L36-B-ED-U-ST-PI-OS	662055176422	80 CRI, 5000K, 36,000 Lumens, Integral On/Off Sensor, Diffuse Wide Distribution Polycarbonate Lens, 0-10V Dimming Driver, 120-277V, White	20	20	S-815UDX
NX Connect (NXCHM)	<input type="checkbox"/> PELA-840-L24-B-ED-U-ST-PI-NXCHM	840141417042	80 CRI, 4000K, 24,000 Lumens, NX Connect Wireless Sensor, Diffuse Wide Distribution Polycarbonate Lens, 0-10V Dimming Driver, 120-277V, White	10	30	S-815UDX
	<input type="checkbox"/> PELA-850-L24-B-ED-U-ST-PI-NXCHM	840141417059	80 CRI, 5000K, 24,000 Lumens, NX Connect Wireless Sensor, Diffuse Wide Distribution Polycarbonate Lens, 0-10V Dimming Driver, 120-277V, White	10	30	S-815UDX
	<input type="checkbox"/> PELA-840-L30-B-ED-U-ST-PI-NXCHM	840141417066	80 CRI, 4000K, 30,000 Lumens, NX Connect Wireless Sensor, Diffuse Wide Distribution Polycarbonate Lens, 0-10V Dimming Driver, 120-277V, White	10	30	S-I9B738
	<input type="checkbox"/> PELA-850-L30-B-ED-U-ST-PI-NXCHM	840141417073	80 CRI, 5000K, 30,000 Lumens, NX Connect Wireless Sensor, Diffuse Wide Distribution Polycarbonate Lens, 0-10V Dimming Driver, 120-277V, White	10	30	S-I9B738
	<input type="checkbox"/> PELA-840-L36-B-ED-U-ST-PI-NXCHM	840141417080	80 CRI, 4000K, 36,000 Lumens, NX Connect Wireless Sensor, Diffuse Wide Distribution Polycarbonate Lens, 0-10V Dimming Driver, 120-277V, White	20	20	S-I9B738
	<input type="checkbox"/> PELA-850-L36-B-ED-U-ST-PI-NXCHM	840141417097	80 CRI, 5000K, 36,000 Lumens, NX Connect Wireless Sensor, Diffuse Wide Distribution Polycarbonate Lens, 0-10V Dimming Driver, 120-277V, White	20	20	S-I9B738
NX Networked Wireless (NXWHM)	<input type="checkbox"/> PELA-840-L24-B-ED-U-ST-PI-NXWHM	603134946321	80 CRI, 4000K, 24,000 Lumens, NX Wireless Sensor, Diffuse Wide Distribution Polycarbonate Lens, 0-10V Dimming Driver, 120-277V, White	10	30	S-WJ94ES
	<input type="checkbox"/> PELA-840-L30-B-ED-U-ST-PI-NXWHM	603134946345	80 CRI, 4000K, 24,000 Lumens, NX Wireless Sensor, Diffuse Wide Distribution Polycarbonate Lens, 0-10V Dimming Driver, 120-277V, White	10	30	S-WJ94ES
	<input type="checkbox"/> PELA-840-L36-B-ED-U-ST-PI-NXWHM	840141432632	80 CRI, 4000K, 36,000 Lumens, NX Wireless Sensor, Diffuse Wide Distribution Polycarbonate Lens, 0-10V Dimming Driver, 120-277V, White	20	20	S-WJ94ES
Accessory	<input type="checkbox"/> Y-CBL-KIT-5FT	603134946437	Aircraft Cable Hangers, 5' pair, w/ hooks connecting to fixture	1.2	N/A	N/A
	<input type="checkbox"/> Y-CBL-KIT-10FT	603134946444	Aircraft Cable Hangers, 10' pair, w/ hooks connecting to fixture	1.7	N/A	N/A
	<input type="checkbox"/> AK_CORD_6FT_3COND_10PC	840141432649	White, 6' 3 Conductor Cord with strain relief, accessory to be installed in field, 10pk	1	N/A	N/A

ACCESSORY ORDERING GUIDE

MOUNTING AND ACCESSORIES				
Mounting Options		Description	Configurable Order Logic Code	Accessories
<input type="checkbox"/>	Standard Chain/ Cable Mount	Available on all fixture configurations (chain not included). Y-Cable w/hook can be ordered as an accessory.	ST = Standard (No chain or mounting hardware included)	Not Applicable
<input type="checkbox"/>	Surface Mount (optional)	Available on all fixture configurations. Attaches to structural member in ceiling. (Hardware not included.)	SM = Surface Mount	Not Applicable
<input type="checkbox"/>	Pendant Mount (optional)	Available on all fixture configurations. Attaches to ¾" threaded conduit. (conduit not included).	PM = ¾" Pendant Mount Kit	Not Applicable
<input type="checkbox"/>	Y-Cable w/hook (optional)	Use with Standard Mounting Option only. Order separately. Priced per pair. 5 ft., 10 ft., 15 ft., 20 ft. lengths available	n/a	5' Y Cable/Hook: 93302310 10' Y Cable/Hook: 93302311 15' Y Cable/Hook: 93306699 20' Y Cable/Hook: 93306750
<input type="checkbox"/>	V-Clips w/ chains (optional)	Use with Standard Mounting Option only. Order separately. Priced per pair. 3 ft. length chains included.	n/a	93146133G

FIELD INSTALLABLE 20W BATTERY KITS*		
	Ordering SKU	PELA Body Size
<input type="checkbox"/>	93313452	Size 2
<input type="checkbox"/>	93313453	Size 3
<input type="checkbox"/>	93313454	Size 1

*Emergency battery pack options are California Energy Commission (CEC) Title 20 compliant

DATE:

LOCATION:

TYPE:

PROJECT:

CATALOG #:

ACCESSORIES ORDERING GUIDE CONT'D.

WIRE GUARDS				
PELA Body Size		SAP #	SAP Description	Master Carton Quantity
<input type="checkbox"/>	PELA Size 1	93318567	CUR HB WG 1	5
<input type="checkbox"/>	PELA Size 1 + End Mount Sensor	93318568	CUR HB WG 1 SMS	5
<input type="checkbox"/>	PELA Size 2	93318569	CUR HB WG 2	10
<input type="checkbox"/>	PELA Size 2 + End Mount Sensor	93318570	CUR HB WG 2 SMS	10
<input type="checkbox"/>	PELA Size 3	93318571	CUR HB WG 3	10
<input type="checkbox"/>	PELA Size 3 + End Mount Sensor	93318572	CUR HB WG 3 SMS	10
<input type="checkbox"/>	PELA Size 4	93318573	CUR HB WG 4	5
<input type="checkbox"/>	PELA Size 4 + End Mount Sensor	93318574	CUR HB WG 4 SMS	5

*SMS = Use with end mount sensor. If ordering fixture with sensor, refer to chart on page 5 of spec sheet to determine if sensor is end mounted. If sensor is end mounted, order wireguard for fixture body size with 'SMS' in description.

All highbay wireguards are priced as single accessories and must be ordered as single accessories. Standard packaging is a master carton containing 5 or 10 wireguards depending on fixture body size.

Ordering example: If quantity (12) of 'CUR HB WG 1' is ordered, the customer will receive (2) master cartons of (5) wireguards + an additional box with (2) wireguards for a total of (12) wireguards.

See Highbay Wireguard Installation Sheet (hyperlink) for more details.

DELIVERED LUMENS

DELIVERED LUMENS AND ELECTRICAL CHARACTERISTICS FOR PELA								
Ordering Code			Delivered Lumens	120-277V		347/480V		Body
CRI/CCT	Lumen	Optic		Watts	LPW	Watts	LPW	
740 750	L09	B	9,100	57	160	60	152	Size 1
	L12		12,100	75	161	77	157	
	L15		15,100	91	166	91	166	
	L18		18,200	114	160	113	161	
	L24		24,000	154	156	152	158	Size 2
	L30		30,000	202	149	201	149	
	L36		36,400	218	167	216	169	Size 3
	L48		48,000	308	156	303	158	
	L60		60,300	343	176	336	179	Size 4
840 850	L09	B	9,100	62	147	65	140	Size 1
	L12		12,100	84	144	84	144	
	L15		15,100	101	150	100	151	
	L18		18,200	126	144	124	147	
	L24		24,000	174	138	171	140	Size 2
	L30		30,000	227	132	225	133	
	L36		36,400	240	152	237	154	Size 3
	L48		48,000	347	138	342	140	
	L60		60,300	380	159	372	162	Size 4

LUMEN OUTPUT MULTIPLIER FOR OPTIC ORDERING CODE		
Optic Lens Code	Optic Description	Lumen Output Multiplier
A	No Lens (120°)	110%
B	Diffused Lens (120°)	100%
C	Clear Lens (120°)	108%
D	Diffused Lens (55°)	103%
E	Diffused Lens (30°)	104%

Delivered Lumens
(in Table on Left)

x

Lumen Output
Multiplier

=

Delivered Lumens for
fixture with A, B, C, D or
E Lens

PROJECTED LUMEN MAINTENANCE

Calculation Method	Ambient Temp	25,000 hrs	50,000 hrs	60,000 hrs
TM-21-11	25C/77F	0.95	0.93	0.92
	50C/122F	0.94	0.90	0.88
TM-21-21	25C/77F	0.95	0.93	0.91
	50C/122F	0.94	0.90	0.89

AMBIENT TEMPERATURE RATINGS

Lumen Code	L09	L12	L15	L18	L24	L30	L36	L48	L60
Max Ambient	50°C	50°C	50°C	50°C	40°C	40°C	40°C	40°C	40°C
Min Ambient	-30°C	-30°C	-30°C	-30°C	-30°C	-30°C	-30°C	-30°C	-30°C

Note: ELL20 Battery Option Ambient Temperature Ratings:
Max ambient temperature ratings are consistent with the values listed above. Minimum ambient temperature rating for ELL20 option is 0°C

NX LIGHTING CONTROLS

	Control Option Ordering Logic & Description		Control Option Functionality									Control Option Components
			Networkable	Standalone Grouping	Scheduling	Occupancy	Daylight Harvesting	0-10V Dimming	On/Off Control	Bluetooth App Programming	Sensor Height	
NX Wireless	NXW	NX Networked Wireless Radio Module NXRM2 and Bluetooth Programming, without Sensor	✓	✓	✓	-	-	✓	✓	✓	-	 NXRM2-H
	NXWHM	NX Networked Wireless Enabled Integral NXSMP2-HMO Wireless High Bay Occupancy & Photocell Sensor	✓	✓	✓	✓	✓	✓	✓	✓	Max: 45ft	 NXSMP2-HMO
NX Wired	NXE	NX Wired Dual RJ45 SmartPORTS , without Sensor	✓	✓	✓	-	-	✓	✓	✓**	-	 NXFSP
	NXEHM	NX Wired Dual RJ45 SmartPORTS and Integral NXSMP2-HMO PIR Occupancy Sensor with Automatic Dimming Photocell and Bluetooth Programming	✓	✓	✓	✓	✓	✓	✓	✓	Max: 45ft	 NXFSP NXSMP2-HMO
NX Independent	NXCHM	NX Connect NXC-WHS20 Wireless High Bay Occupancy & Photocell Sensor	-	✓	-	✓	✓	✓	✓	✓*	Low Max: 8ft Med. Max: 20ft High Max: 40ft	 NXC-WHS20
	WSPD360	End Mounted WSPDEMUNV PIR Occupancy Sensor with Automatic Dimming Photocell and 360° Lens	-	-	-	✓	✓	✓	-	-	Max: 45ft	 WSPDEMUNV
	WSPDA	End Mounted WSPDEMUNV PIR Occupancy Sensor with Automatic Dimming Photocell and Aisle Lens	-	-	-	✓	✓	✓	-	-	Max: 45ft	 WSPDEMUNV
	WSPDBT360	End Mounted Bluetooth® Programmable, WSPDBEMUNV Occupancy Sensor with Automatic Dimming Photocell and 360° Lens	-	-	-	✓	✓	✓	✓	✓	Max: 45ft	 WSPDBEMUNV
	WSPDBTA	End Mounted Bluetooth® Programmable, WSPDBEMUNV Occupancy Sensor with Automatic Dimming Photocell and Aisle Lens	-	-	-	✓	✓	✓	✓	✓	Max: 45ft	 WSPDBEMUNV
	OS1360	End Mounted WSPDEMUNV PIR On/Off Occupancy/ Daylight Sensor with 360° Lens	-	-	-	✓	✓	-	On/Off Only No Dim	-	Max: 45ft	 WSPDEMUNV
	OS1A	End Mounted WSPDEMUNV PIR On/Off Occupancy/ Daylight Sensor with Aisle Lens	-	-	-	✓	✓	-	On/Off Only No Dim	-	Max: 45ft	 WSPDEMUNV
Other Independent Control	OS	End Mounted LSXR PIR On/Off Sensor 360° High Mount Sensor	-	-	-	✓	-	-	On/Off Only No Dim	-	Max: 45ft	 LSXR6LT
	OCS	End Mounted LSXR PIR On/Off Occupancy/Daylight Sensor 360° High Mount Sensor	-	-	-	✓	✓	-	On/Off Only No Dim	-	Max: 45ft	 LSXR6PLT
	ODS	End Mounted LSXR PIR Dimming Occupancy Sensor 360° High Mount Sensor	-	-	-	✓	-	✓	-	-	Max: 45ft	 LSXR6HLLT

* Requires use of NX Connect App available for download from Apple app store

** Requires NXBTC (bluetooth programming tool), order separately

CONTROLS

DEFAULT SETTINGS

NX Wireless & Wired	Occupancy Sensor	Enabled
	Occupancy Sensor Sensitivity	7 Minutes
	Occupancy Sensor Timeout	15 Minutes
	Occupied Dim Level	100%
	Unoccupied Dim Level	0% (OFF)
	Daylight Sensor	Disabled
	Bluetooth	Enabled
	2.4GHz Wireless Mesh	Off
	"Passcode	Enabled
	Factory Passcode: HubbN3T!"	
NX Independent - WSPDBT360/WSPDBTA	Occupancy Sensor	Enabled
	Occupancy Sensor Sensitivity	7 Minutes
	Occupancy Sensor Timeout	8 Minutes
	Occupied Dim Level	100%
	Unoccupied Dim Level	0% (OFF)
	Daylight Sensor	Disabled

NX Independent - NX Connect	Settling/Dwell Time	5 sec
	Hold Time	15 min
	Group Hold Time	15 min
	Grace Time	0 sec
	Strategy	-
	Occupancy Sensitivity	5 (highest)
	Occupancy Indicator	1 (enabled)
	Partial Off/Standby	0%
	Background Level	10%
	Task Level	100%
	Daylight Harvesting	1 (enabled)
	Low Ambient Output	250% (of fixtures light output)
	High Ambient Output	OFF
NX Independent - WSPD360/WSPDA	Occupancy Sensor Timeout	8 Minutes
	Occupied Dim Level	100%
	Unoccupied Dim Level	50%
	Full Off Timeout	Disabled
	Daylight Sensor	Disabled

PRODUCT IMAGE

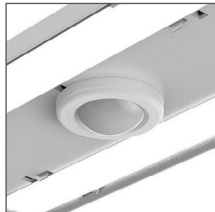

NXWHM
NXEHM



NXCHM



WSPD360 / WSPDA
WSPDBT360 / WSPDBTA
OS1350 / OS1A

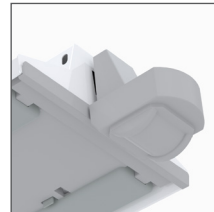

OS / OCS / ODS

CONTROLS TECHNICAL SUPPORT

1-800-888-8006 (7:00 am–7:00 pm est)

APP INFORMATION

NX Lighting Controls App



The NX Lighting Controls App is a free to use mobile application for programming both an NX Lighting Controls System or Standalone Bluetooth Sensors. The mobile app allows you to configure devices, discover and setup wireless enabled luminaires and program your NX system settings.



Android



Apple iOS

NX Connect App



The NX Connect mobile App is a free to use mobile application for programming a NX Connect System. The mobile App allows you to discover, configure and share your NX Connect system.



Apple iOS

INTEGRATED SENSORS

FIELD CHANGEABLE NX-WHS20 SENSOR ACCESSORIES



Ordering Sku	Ordering Cat# Logic	Description
93134999	NX- WHS20_LOW_LENS_KIT_10	Low Lens: 2.5m (8ft) - 10pk
93135001	NX- WHS20_MED_LENS_KIT_10	Med Lens: 6m (20ft) - 10pk
93135003	NX- WHS20_HIGH_LENS_KIT_10	High Lens: 12m (40ft) - 10pk
93134985	NX- WHS20_SNAP_AISLE_MASK_KIT_10	Snap on Aisle Mask

Note: See NX-WHS20 spec sheet for Occupancy Detection Patterns

COVERAGE PATTERNS

NXWHM (NXSMP2-HMO SENSOR) NXEHM (NXSMP2-HMO)

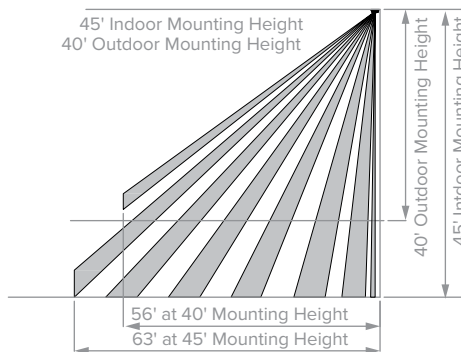

Sensor Lens Coverage and Detection Patterns When Mounted at 40ft and 45ft with Standard Lens

NXCHM (NXC-WHS20 SENSOR) HIGH LENS: 12.2M (40FT) 27ft Radius/54ft Diameter

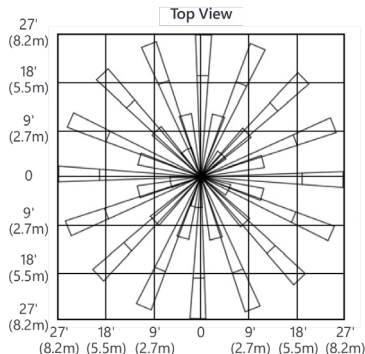
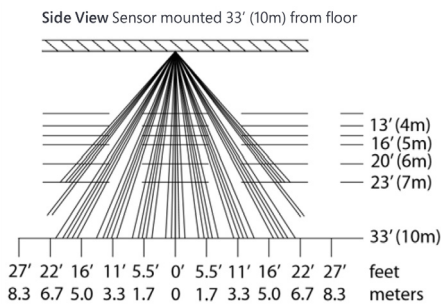

NXCHM (NXC-WHS20 SENSOR) MED LENS: 6M (20FT) 30ft Radius/60ft Diameter

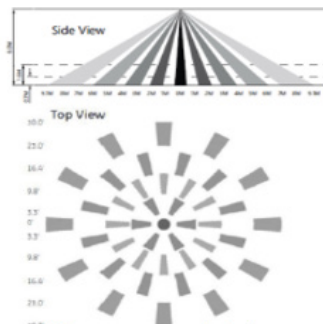

WSPD360/WSPDA/WSPDBT360/ WASDBTA/OS1360/OS1A

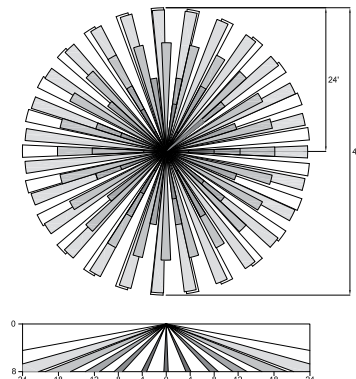

NXCHM (NXC-WHS20 SENSOR) LOW LENS: 2.5M (8FT) 20ft Radius/40ft Diameter

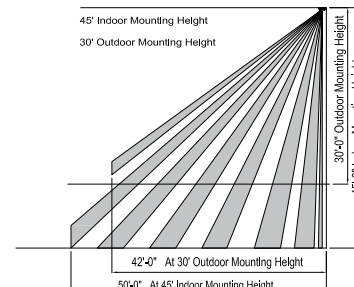
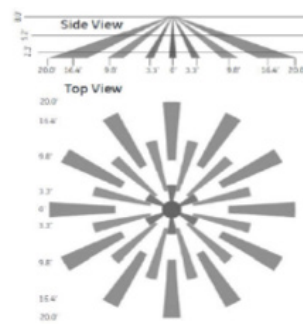

OTHER LIGHTING CONTROLS

OS, OCS, ODS
COVERAGE PATTERNS

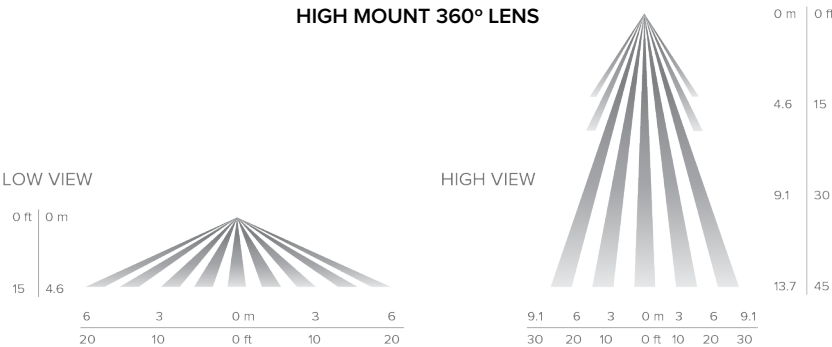

FUNCTIONALITY AND DEFAULT SETTINGS

Name	Description	Minimum Value	Maximum Value	Default Values for Cat Logic Choice		
				OS	OCS	ODS
Occupancy Time Delay (1 Pole)	The length of time the sensor will keep the lights controlled by relay 1 on at full bright after it last detects occupancy, assuming Minimum On Time has been met.	30 sec	30 min	10 min	10 min	10 min
Occupancy Time Delay (2 Pole)	The length of time the sensor will keep the lights controlled by relay 2 on after it last detects last occupancy, assuming Minimum On Time has been met.	N/A	30 min	10 min	10 min	10 min
Photocell Set-Point	The target light level (at the sensor) that is to be maintained.	Auto	64fc	N/A	N/A	4fc
Sunlight Discount Factor	Value used to improve the tracking for accuracy of a sensor with a photocell during periods of high daylight. Decreasing the value will lower the controlled level of the lights.	x/1	x/10	N/A	N/A	x/1
Dimming Range Max (High Trim)	The maximum output level of a sensor with dimming.	Off	10 VDC	N/A	10 VDC	10 VDC
Dimming Range Low (Low Trim)	The minimum output level to which the photocell will dim the lights.	Off	10 VDC	N/A	1 VDC	1 VDC
Dual Zone Photocell %	Relative value of photocell set-point that is used to control relay 2.	110%	200%	N/A	N/A	150%
Dim to Off Occupancy Time Delay	After Occupancy Time Delay has expired, this setting specifies the amount of time lights are held at minimum dim before turning off.	0 sec	Never Off	0 sec	0 sec	0 sec

DATE:	LOCATION:
TYPE:	PROJECT:
CATALOG #:	

PACKAGING/SHIPPING INFO

JOB PACKAGING IS STANDARD

Note: Orders less than 14 fixtures are typically sent Packaged Individually

SLEEVE

Size 1



Size 2 & Size 3

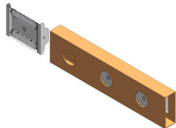

LAYER

Size 1

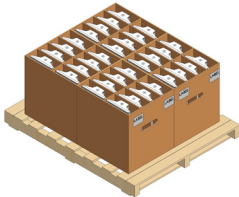

Size 2 & Size 3

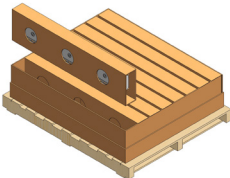

PALLET

Size 1



Size 2 & Size 3

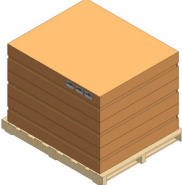

JOB PACK DETAILS			
Size	Fixtures per Sleeve	Sleeves per Layer	Layers per Pallet
1	8	4	2
2	3	8	3
3	1	8	3

JOB PACK PALLET QTYS			
Pallet Dimensions			
Size	Standard Fixture Qty	L (in) x W(in)	H (in)
1	64	52 x 42	45.5
2	72	52 x 42	39.0
3	24	52 x 42	39.0

JOB PACK PALLET QTYS FOR FIXTURES W/ OPTIONS					
Fixture Options					
Cord	EL Pack	Bottom Sensor	Bottom Mt Sensor & Cord	Side Mt Sensor	Side Mt Sensor & Cord
48	42	48	48	42	42
63	48	72	63	48	48
21	21	24	21	24	21

PACKAGED INDIVIDUALLY: OPTION SELECTION PI

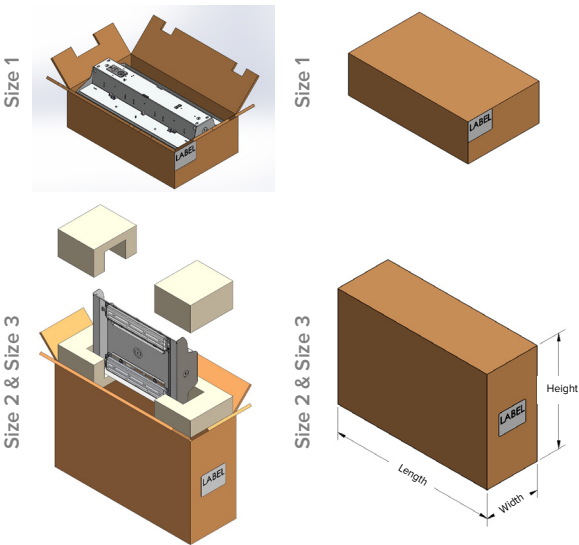

Packaged Individually Box Dimensions			
Size	Length (in)	Width (in)	Height (in)
1	20.0	12.0	6.0
2	22.3	7.5	15.0
3	36.5	7.5	15.0

Packaged Individually Pallet Qty & Dimensions			
Size	Qty	L (in) x W (in)	Height (in)
1	56	52 x 42	47.0
2	30	52 x 42	49.0
3	20	52 x 42	48.0

Note: Packaged Individually dimensions do not change if sensor, cord, or EL Pack option is added to fixture

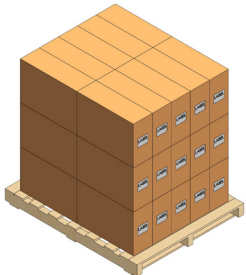

DIMENSIONS

PELA SIZE 1

L09, L12, L15, & L18 LUMEN OUTPUT

Max Weight: 6 lbs

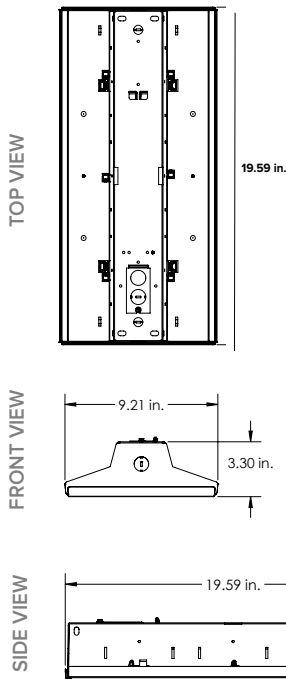

PELA SIZE 2

L24 & L30 LUMEN OUTPUT

Max Weight: 10 lbs

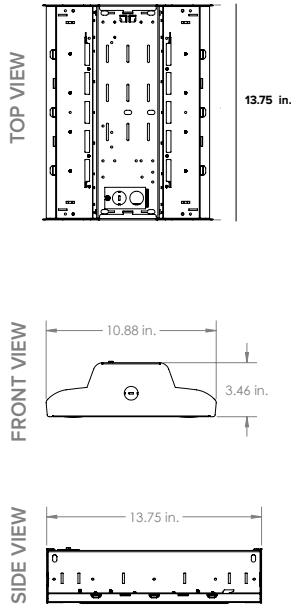

PELA SIZE 3

L36 & L48 LUMEN OUTPUT

Max Weight: 20 lbs

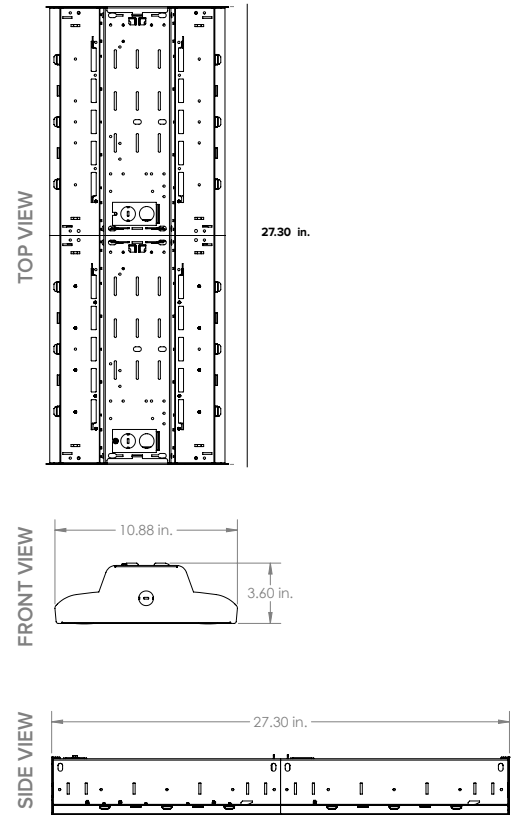

PELA SIZE 4

L60 LUMEN OUTPUT

Max Weight: 22 lbs

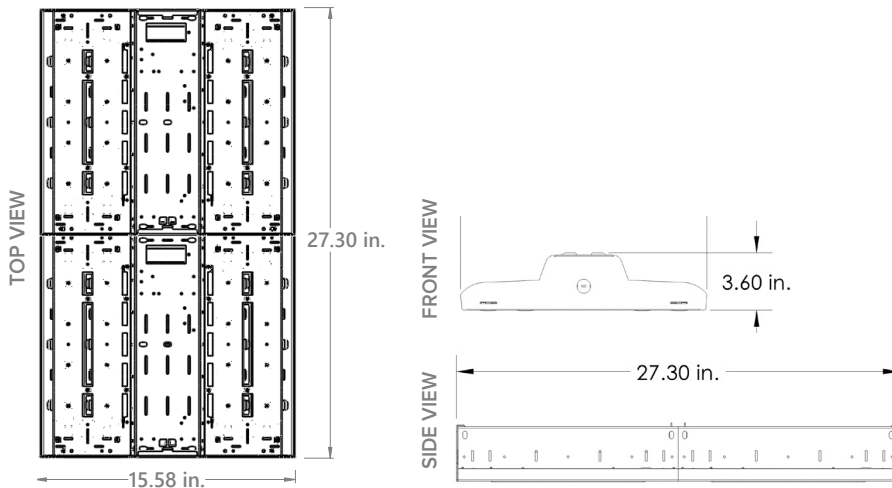

EMERGENCY BATTERY INFORMATION

Note: Location of ELL20 battery option is shown in RED below

Lumens in Emergency Mode = LPW of Fixture x EM Pack Wattage (20 watts)

PELA SIZE 1

L09, L12, L15, & L18 LUMEN OUTPUT

VOLTAGE: U, 120V, & 277V

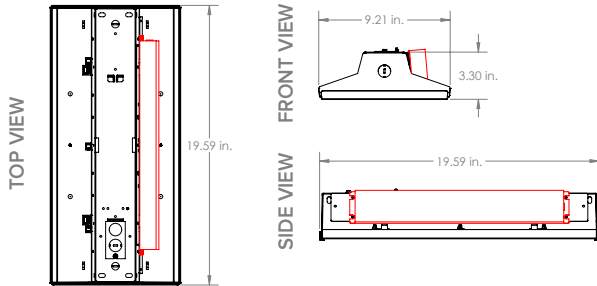

VOLTAGE: 347V & 480V

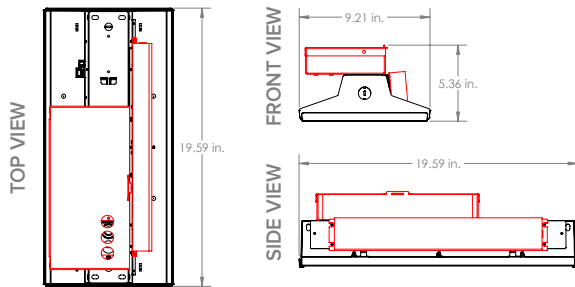

PELA SIZE 2

L24 & L30 LUMEN OUTPUT

VOLTAGE: U, 120V, & 277V

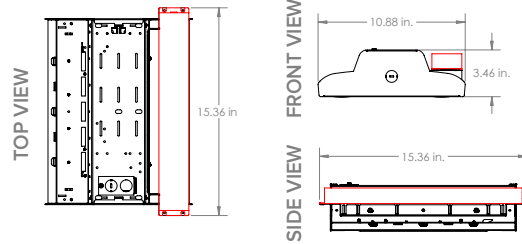

VOLTAGE: 347V & 480V

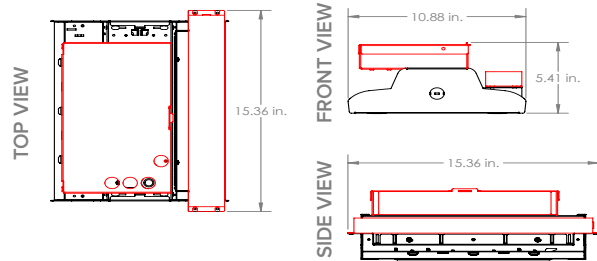

PELA SIZE 3

L36 & L48 LUMEN OUTPUT

VOLTAGE: U, 120V, & 277V

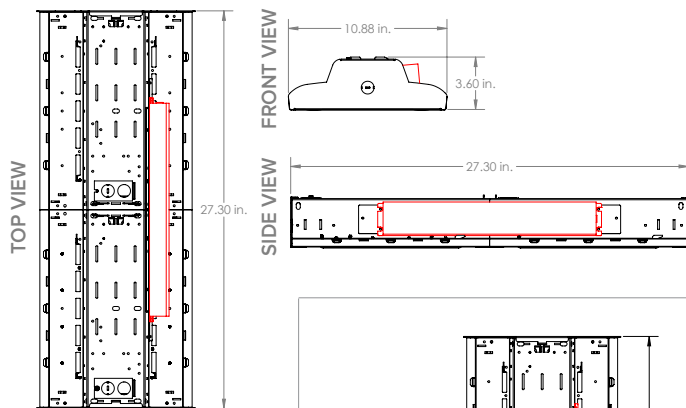

VOLTAGE: 347V & 480V

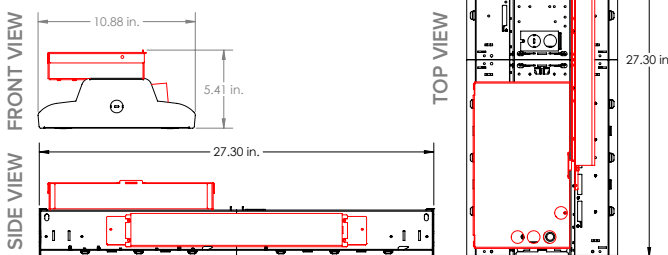

PELA SIZE 4

L60 LUMEN OUTPUT

VOLTAGE: U, 120V, & 277V

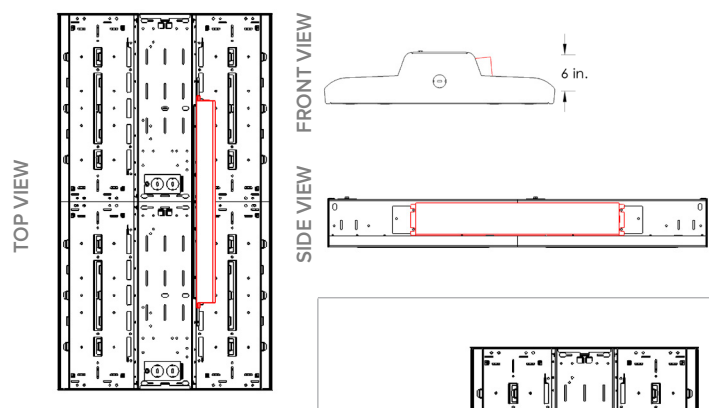

VOLTAGE: 347V & 480V

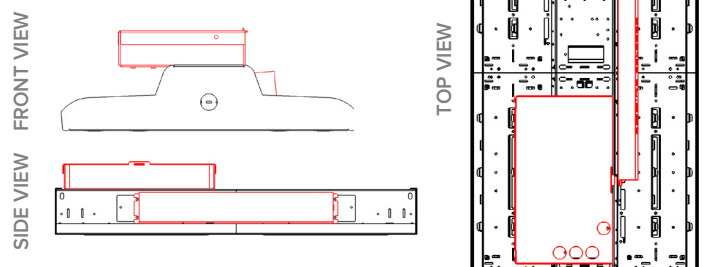

PHOTOMETRY

PELA-840L30-A-XXX

LUMINAIRE DATA

Description	Linear Highbay; 30,000 Lumens; No Lens (120)
Delivered Lumens	33,000
Watts	227
Efficacy	145
Spacing Criterion	0°= 1.30 90°= 1.30

ZONAL LUMEN SUMMARY

Zone	Lumens	% Luminaire
0-20	4336.26	13.10
0-30	9318.28	28.20
0-40	15393.24	46.60
0-60	27596.01	83.60
0-80	32795.71	99.40
0-90	32953.71	99.90
10-90	31843.63	96.50
20-40	11056.97	33.50
20-50	17426.24	52.80
40-70	16145.67	48.90
60-80	5199.70	15.80
70-80	1256.80	3.80
80-90	158.00	0.50
90-110	6.51	0.00
90-120	11.02	0.00
90-130	16.74	0.10
90-150	31.01	0.10
90-180	45.85	0.10
110-180	39.34	0.10
0-180	32999.56	100.00

POLAR GRAPH

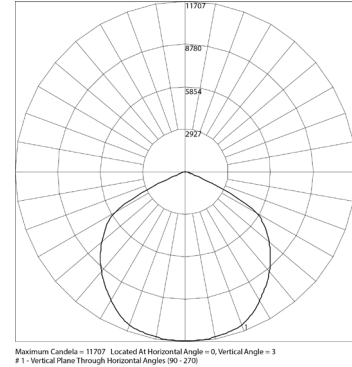

PELA-840L30-B-XXX

LUMINAIRE DATA

Description	Linear Highbay; 30,000 Lumens; Diffused Lens (120)
Delivered Lumens	30,000
Watts	227
Efficacy	132
Spacing Criterion	0°= 1.22 90°= 1.22

ZONAL LUMEN SUMMARY

Zone	Lumens	% Luminaire
0-20	4059.62	13.50
0-30	8521.12	28.40
0-40	13728.40	45.80
0-60	23466.33	78.20
0-80	29014.12	96.70
0-90	29753.87	99.20
10-90	28698.74	95.70
20-40	9668.79	32.20
20-50	14861.19	49.50
40-70	13191.07	44.00
60-80	5547.79	18.50
70-80	2094.64	7.00
80-90	739.75	2.50
90-110	57.22	0.20
90-120	92.44	0.30
90-130	132.14	0.40
90-150	203.09	0.70
90-180	246.09	0.80
110-180	188.87	0.60
0-180	29999.96	100.00

POLAR GRAPH

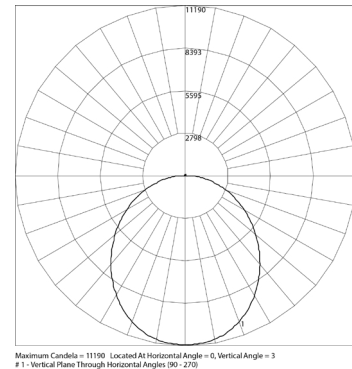

PELA-840L30-C-XXX

LUMINAIRE DATA

Description	Linear Highbay; 30,000 Lumens; Clear Lens (120)
Delivered Lumens	32,400
Watts	227
Efficacy	143
Spacing Criterion	0°= 1.30 90°= 1.30

ZONAL LUMEN SUMMARY

Zone	Lumens	% Luminaire
0-20	4257.43	13.10
0-30	9148.86	28.20
0-40	15113.38	46.60
0-60	27094.28	83.60
0-80	32199.42	99.40
0-90	32354.59	99.90
10-90	31264.71	96.50
20-40	10855.95	33.50
20-50	17109.39	52.80
40-70	15852.10	48.90
60-80	5105.14	15.80
70-80	1233.94	3.80
80-90	155.17	0.50
90-110	6.51	0.00
90-120	11.02	0.00
90-130	16.74	0.10
90-150	30.78	0.10
90-180	45.33	0.10
110-180	38.82	0.10
0-180	32399.92	100.00

POLAR GRAPH

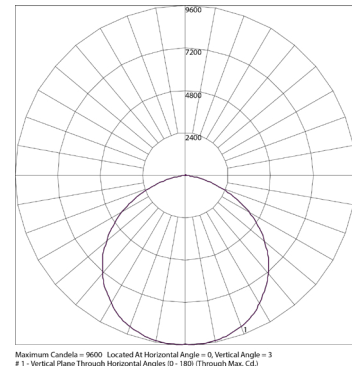

PHOTOMETRY

PELA-840L30-D-XXX

LUMINAIRE DATA

Description	Linear Highbay; 30,000 Lumens; Diffused Lens (55)
Delivered Lumens	30,900
Watts	227
Efficacy	136
Spacing Criterion	0°= 1.36 90°= 0.94

ZONAL LUMEN SUMMARY

Zone	Lumens	% Luminaire
0-20	7077.35	22.90
0-30	14379.83	46.50
0-40	21374.12	69.20
0-60	28509.94	92.30
0-80	30559.83	98.90
0-90	30790.07	99.60
10-90	28917.99	93.60
20-40	14296.77	46.30
20-50	18873.45	61.10
40-70	8501.75	27.50
60-80	2049.89	6.60
70-80	683.96	2.20
80-90	230.24	0.70
90-110	19.09	0.10
90-120	36.33	0.10
90-130	53.41	0.20
90-150	82.73	0.30
90-180	109.79	0.40
110-180	90.71	0.30
0-180	30899.86	100.00

POLAR GRAPH

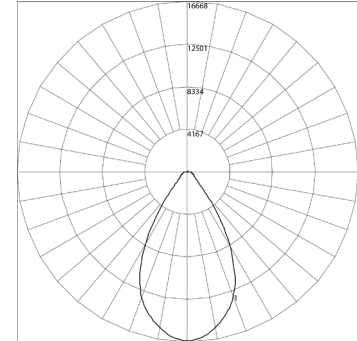

Maximum Candela = 16668 Located At Horizontal Angle = 5, Vertical Angle = 1
1 - Vertical Plane Through Horizontal Angles (90 - 270)

PELA-840L30-E-XXX

LUMINAIRE DATA

Description	Linear Highbay; 30,000 Lumens; Diffused Lens (30)
Delivered Lumens	31,200
Watts	227
Efficacy	137
Spacing Criterion	0°= 1.32 90°= 0.62

ZONAL LUMEN SUMMARY

Zone	Lumens	% Luminaire
0-20	8768.54	28.10
0-30	15723.68	50.40
0-40	21399.32	68.60
0-60	28143.11	90.20
0-80	30767.30	98.60
0-90	31056.20	99.50
10-90	28540.45	91.50
20-40	12630.78	40.50
20-50	16729.17	53.60
40-70	8422.93	27.00
60-80	2624.19	8.40
70-80	945.06	3.00
80-90	288.90	0.90
90-110	27.23	0.10
90-120	50.36	0.20
90-130	74.44	0.20
90-150	111.78	0.40
90-180	143.40	0.50
110-180	116.17	0.40
0-180	31199.60	100.00

POLAR GRAPH

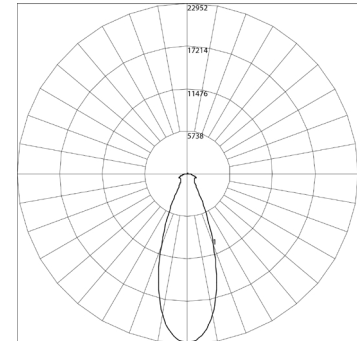

Maximum Candela = 22952 Located At Horizontal Angle = 0, Vertical Angle = 1
1 - Vertical Plane Through Horizontal Angles (90 - 270)